

# 9917MR

2014 + GM TRUCK FRONT AND REAR LOWERING MAGNERIDE KIT  
DESIGNED TO FIT OUR 2/4, 3/5 AND 4/6 DROP KITS



## PARTS LIST:

- (2) 9915MR front sensor rods
- (2) 9915MR2 rear sensor rod plates
- (2) M6-1.0 nylock nuts

**NOTE:** This sensor rod components kit should be installed as the truck is being put back together after installing the lowering kit.

**NOTE:** If you are only installing drop spindles, the rods will not need to be used.

**STEP 1:** Separate the front sensor rod from both mounting points and remove.



**STEP 2:** The plastic rod ends are held onto the sensor rod by a rib engaged into a retaining groove. To separate, tighten the rod into a vise and use a pair of pliers to pry the rod end off. Repeat for both rod ends.



**STEP 3:** If installing 1" drop coils, you will pop the rod ends onto the new rod as is and install it back onto the truck. **IF NOT, PROCEED TO STEP 4.**

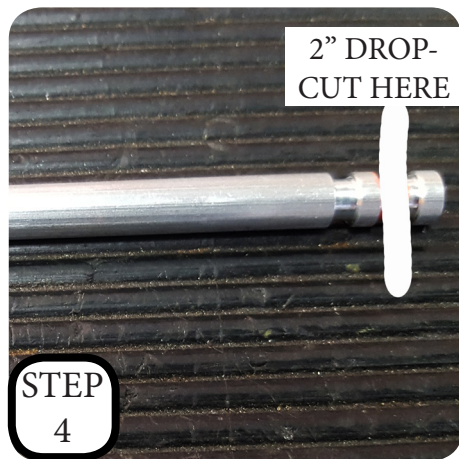

**STEP 4:** If you are installing 2" drop coils, then you will need to cut off the end of the new rod, right where the first groove ends, then install the rod ends and install back onto the truck.



**STEP 5:** The rear sensor plate will need to be installed as soon as the axle is flipped and the U-bolts are ready to be installed. Remove the mounting ball from the original plate and re-attach it to the new plate using the provided 6mm nut.

**NOTE:** If installing a 4" or 6" drop, the ball will be installed in the furthest hole.



**NOTE:** If installing a 5" drop, the ball will be installed in the closer hole.







#### 4 inch drop

**STEP 6:** Now place the new plate in-between the leaf spring and the axle relocater.

**NOTE:** If installing a 4” flip kit, the new sensor plate will orient towards the front of the axle and upward.



#### 5 inch drop

**NOTE:** If installing a 5” or 6” flip kit, the sensor plate will need to orient towards the front of the axle and downward.



#### 6 inch drop

**STEP 7:** Once the plate is installed and the U-bolts are tight, attach the rod to the ball joint.